

Australia's Great Train Journeys



Great Southern Rail Journeys of Discovery

Imagine waking up to see the sun rising over Australia's Red Centre or watching the majestic Blue Mountain slide past. Imagine Australia's fabled Outback unfolding before you, or seeing golden farmlands shimmering in the afternoon light. Whichever way you look at it, there's no other travel experience that compares with seeing this country on board Australia's two great train journeys.

More than simply a mode of transport or a holiday experience, a train journey becomes an unforgettable odyssey. As the carriages weave through the tapestry of the landscape and its rich palette of colours, other travellers – rushing to their destinations at 35,000 feet above you – miss the wonders of the Australian countryside.

In the Top End, find yourself in a land of soaring sandstone cliffs, lush forests and rich Indigenous culture. The ancient mysteries of Katherine Gorge in Nitmiluk National Park are yours to explore through one of three complimentary Off Train Excursions exclusive to guests of The Ghan.

Sit back and watch the horizons expand over South Australia's agricultural heartland. The rugged 540 million year old Flinders Ranges emerge from the distance as the train winds its way to Port Augusta, the crossroads between the Flinders and the rest of your Outback adventure.

Whether you are on The Ghan or Indian Pacific, your holiday begins the moment you step aboard. A choice of service levels offers travellers the opportunity to experience this remarkable land in a style that suits each taste and budget. And when you travel in Platinum or Gold Service, everything – including excursions – is covered by your all-inclusive fare.

Whether you are relaxing in your private cabin or taking it easy in a comfortable Red Service seat, you can take the short stroll to the bar, settle into conversation with fellow travellers, immerse yourself in a good book, or enjoy a relaxing meal with new friends. If travelling in Platinum or Gold Service, this can all be done in the knowledge that your all-inclusive fare takes care of any extra costs for food, drinks or excursions, leaving you free to relax into the journey even more.

After all, it's all about making your journey a true holiday.

Contents

All Inclusive Offering

- 2 Discover the heart of Australia in 2014
- 4 Wining and dining on board

Journeys and Service Levels

- 6 The Ghan
- 8 Indian Pacific
- 10 Private Carriages
- 12 Platinum Service
- 14 Gold Service
- 16 Red Service
- 17 The Overland

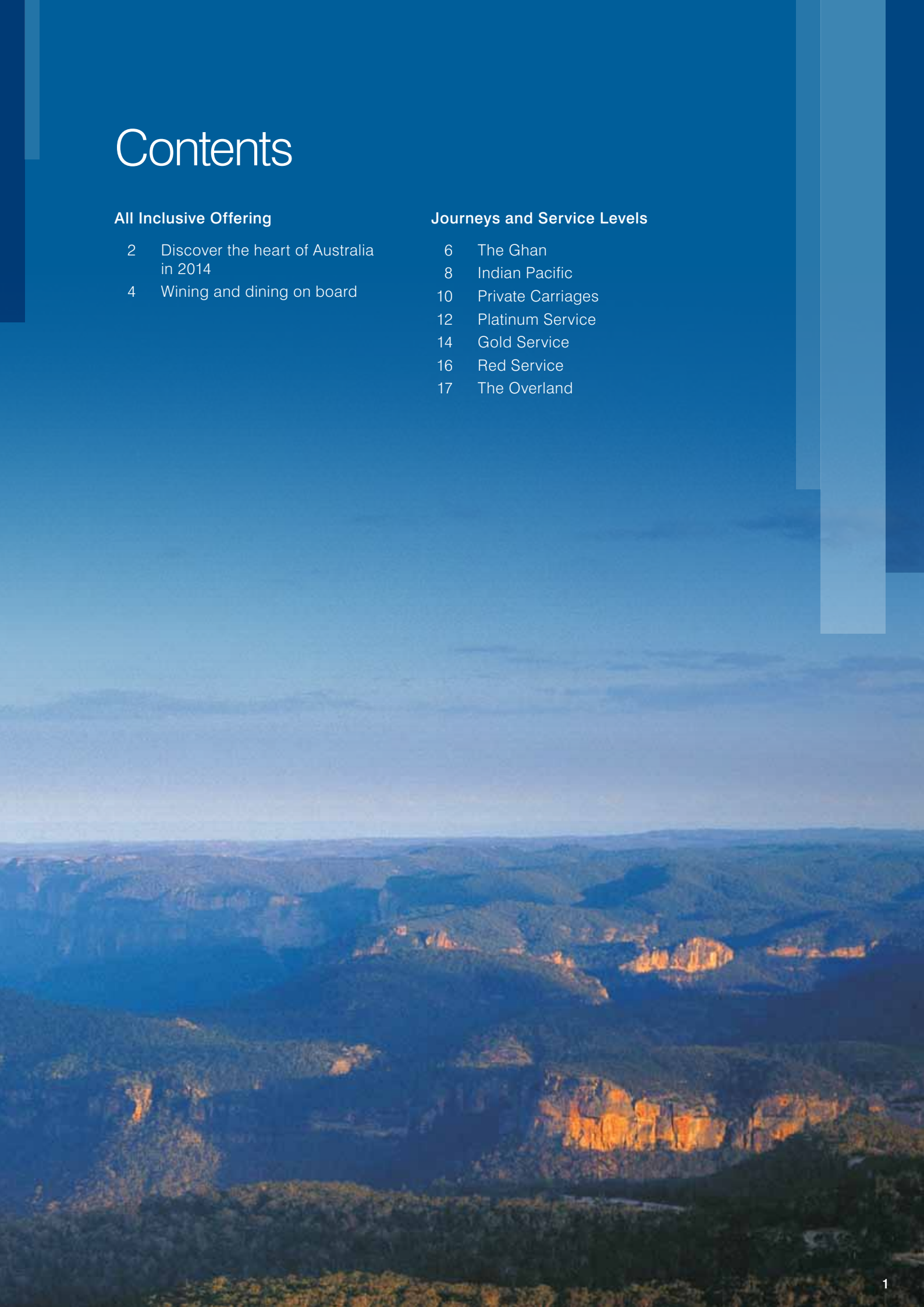

Discover the heart of Australia in 2014

See why The Ghan and Indian Pacific are renowned as two of the world's great train journeys, with Off Train Excursions that will show you more of the heart of Australia. Your journey will pause at selected stops to allow you to explore some of the iconic sights of Outback Australia, with insights into the natural and cultural attractions that make this country unique.





Platinum and Gold Service fares on The Ghan and Indian Pacific are inclusive of all meals, beverages and Off Train Excursions.

Offering high levels of service and hospitality and a flexible on-board experience, we put our guests' comfort first, ensuring every experience will be unforgettable. Services are designed to make your next journey into Australia's Outback truly spectacular.

Meal times are flexible and our menus showcase Australia's finest regional produce. And even better – all meals and standard drinks, including beer and wine, soft drinks and spirits, are included in your fare.

Taking a 'foodie' tour of Adelaide's Central Market, cruising the ancient waterway of Katherine Gorge, or getting dust on your boots in the deserts of the Red Centre...all these experiences and more await you on our Off Train Excursions, which are exclusive to Platinum and Gold Service guests and included in the fare.





Wining and dining on board

Whether you're up with the sun – determined not to miss a minute of your trip – or a lover of the lie-in, flexible breakfast times allow you to savour the first meal of the day at your own pace. After all, you are on holiday.



With flexible reservation options, dining aboard The Ghan and Indian Pacific is as easy as booking your lunch and dinner for the time that suits you best. Stay longer over lunch to chat with new friends, or book a table for two for an intimate dinner later in the evening.

Whether it's for breakfast, brunch, lunch or dinner, you'll find the menu brims with choices. Our menus focus on sourcing local food and wine from the regions of Australia we journey through from traditional Eggs Florentine

to Barossa Valley chorizo, Darwin barramundi or Coorong Angus beef or Coffin Bay oysters. You can pair these with fine wines from Australia's beautiful wine regions, such as the Barossa Valley, Hunter Valley and Margaret River.

All standard drinks – wine, beers, soft drinks and spirits – are included for Platinum and Gold Service travellers. Wines are chosen to complement the local specialities.

THE GHAN

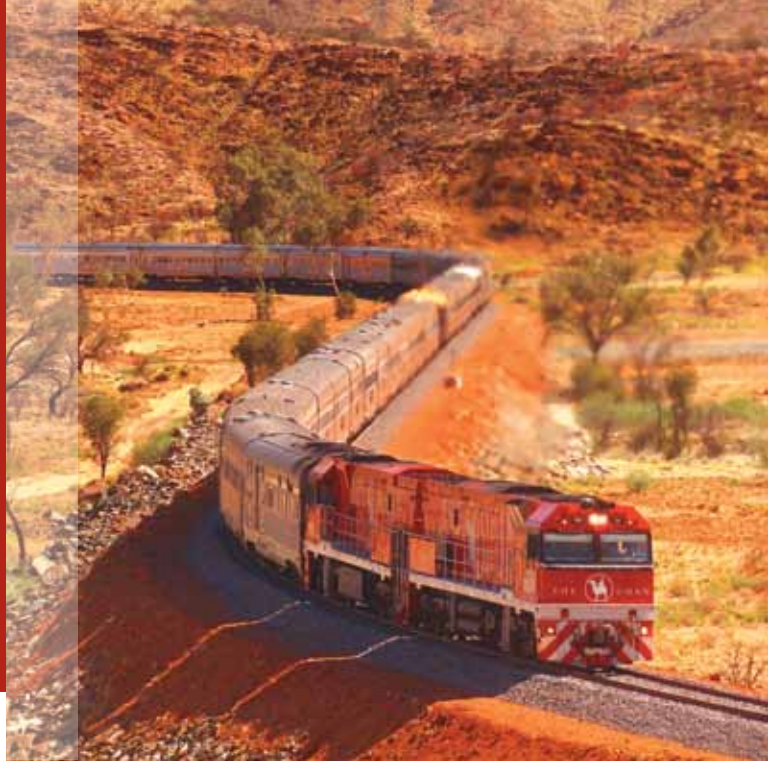

The Ghan

By rail through the red heart to the tropics. You'll never see Australia like this any other way.

The Ghan has been traversing the heart of Australia for more than eighty years. Now it's your turn to explore the continent's vast and remote interior. For three days and two nights, you will discover the Red Centre and the landscapes of this extraordinary land at a relaxing pace, in comfort and style.

Whether you begin in Adelaide or Darwin, your trip will take in the sweeping Adelaide Plains and the majestic Flinders Ranges of South Australia, and the ochre heart of the Red Centre.

Each new day begins with a fresh panorama. Awake to the essence of Central Australia as it takes on a character of its own with each passing hour. At the end of each day, relax with a drink as you soak up the sight of a fiery Outback sunset.

In the Outback melting pot of Alice Springs, you'll have time to explore the town that is home to doctors who fly, camels that race and regattas hosted annually on parched riverbeds. Alice Springs Desert Park makes for an unforgettable stop where you can get up close with Australia's unique flora and fauna.



Follow in the footsteps of the Afghan pioneers who gave The Ghan its name, explore a town full of true-blue Aussie character, and visit attractions including the historic Alice Springs Telegraph Station.

In the Top End, you'll take a cruise to witness the splendour of Katherine Gorge in Nitmiluk National Park and see ancient rock art sites, or try your hand at spear throwing and Indigenous painting on a cultural tour. After all this, you'll arrive in the vibrant tropical capital of Darwin, where even more adventures await.

Did you know?

Alice Springs is around 460km from Uluru (Ayers Rock). But we make it easy for you to break your journey and spend even longer getting to know the mysteries of the intriguing Red Centre.

See pages 18-25 for suggested holiday packages.

The Journey

Adelaide to Darwin or vice versa –
Two nights and three days via Alice Springs and Katherine, one way, 2,979km.

Darwin to Alice Springs or vice versa –
One night and two days via Katherine, one way, 1,420km.

Adelaide to Alice Springs or vice versa –
One night and two days, one way, 1,559km.

Service levels available:





Indian Pacific

The Indian Pacific offers travellers one of the most impressive and indulgent ways to explore the vastness of Australia.

From the Indian Ocean on Australia's western shores to the Pacific on the east – the two oceans that give the train its name – you will watch the passing backdrop of Australia's magnificent landscapes. Travel in either direction – from the 'harbour city' of Sydney in the east or the lovely Western Australian capital, Perth – with a stop in Adelaide along the way.

Connecting three of Australia's most historic cities, the Indian Pacific provides you with a unique window to Outback Australia. It is the journey of a lifetime, from one side of Australia to the other.

Your epic journey will take you through the picturesque and fertile Avon Valley, the dusty goldfields around Kalgoorlie in Western Australia, across the vast and ancient desert of the Nullarbor Plains, to the isolated but intriguing outpost of Cook. Journey through Adelaide and the magnificent and once-impenetrable Blue Mountains.

With our Off Train Excursions you will have time to experience the incredible diversity of Australia. Visit the heritage and culture of the 'Silver City', Broken Hill famous for mining, acclaimed Outback artist Pro Hart and the many hotels including the Palace Hotel



(of *Priscilla Queen of the Desert* fame). In the elegant South Australian capital, Adelaide, indulge yourself with a gourmet tour of the Central Market or discover its history and culture on a city tour. In Outback Kalgoorlie you'll be astounded at the aptly-named 'Super Pit', an insight into just how big the mining business is!

The Journey

Sydney to Perth or vice versa –

Three nights and four days via Broken Hill, Adelaide, Cook and Kalgoorlie, one way, 4,352km.

Sydney to Adelaide or vice versa –

One night and two days via Broken Hill, one way, 1,693km.

Perth to Adelaide or vice versa –

Two nights and three days via Cook and Kalgoorlie, one way, 2,659km.

Service levels available:



Did you know?

You can break your journey in Adelaide. Why not stay for a week to discover the Barossa Valley, Murray River and Kangaroo Island.

See pages 26-33 for suggested Holiday Packages.





Private Carriages

For business or pleasure, the ultimate in luxury rail travel.

For a truly unforgettable journey, nothing compares to the indulgence, spaciousness and exclusivity of travelling in your own private rail carriage.

Great Southern Rail boasts two Private Carriages in its fleet, available for charters from Sydney, Melbourne, Perth, Adelaide, Alice Springs or Darwin.

For an adventure across the length or breadth of Australia, a Private Carriage aboard The Ghan and Indian Pacific provides the ultimate opportunity to share the excitement and romance of rail

travel with your family or friends. Alternatively, consider coordinating a work conference with a difference by booking a daylight journey aboard The Overland.

The deluxe Sir John Forrest Carriage features wide picture windows and a generous lounge area that can be converted into a spacious boardroom ideal for executive meetings or corporate events. Up to six guests can enjoy comfortable accommodation in two twin cabins and one double cabin, each with individual en suites.



Sir John Forrest Carriage - floor plan



The Chairman's Carriage - floor plan

The elegantly-appointed Chairman's Carriage offers a private dining room and kitchen, spacious living area and accommodation for up to eight guests across two double cabins and two twin cabins.

Your Private Carriage experience comes with all the advantages of Platinum Service travel, including chauffeured transfers at the start and conclusion of your journey, increased luggage allowances, priority selection for a range of Off Train Excursions and all inclusive restaurant dining in the Queen Adelaide Restaurant.

Guests are welcome to socialise with fellow guests over complimentary standard beverages in the Outback Explorer Lounge or relax in the comfort of their own living area, which includes a well-stocked mini bar, plasma screen and DVD and CD players.

Special arrangements can be accommodated to provide a completely personalised travel experience for your celebration or event.



All onboard meals with regional menu.



Standard alcoholic/non alcoholic beverages.



Increased rail luggage allowance.



Off Train Excursions.



Private Transfers.



During the day, our cabin will be configured as a private lounge, with deluxe lounge seating, a table and two ottomans. By night, they convert to a comfortable bedroom, with either a double bed or twin beds.



Platinum Cabin by day

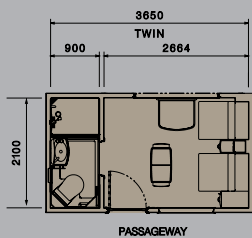
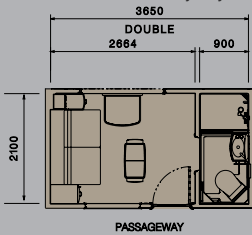

Platinum Cabin by night

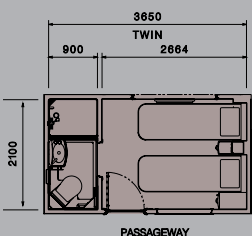
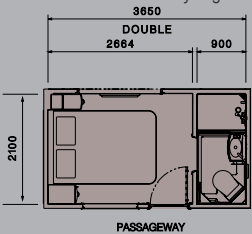

Platinum Service

Service befitting the rail experience of a lifetime.

Exclusivity and elegance are synonymous with Platinum Service travel. You'll feel pampered and warmly welcomed as you take the best seat in the house.

With dedicated cabin steward service, in-cabin music, journey commentary and much more, Platinum Service is designed to make your rail adventure truly unbeatable.

From your private cabin, you won't miss a thing as the world rolls by outside. Expansive panoramic windows frame the landscape, and all cabins also have an interior window, allowing views from both sides of the train.

Each spacious private cabin has a full en suite. At almost double the size of Gold Service cabins, they have premium fittings, a shower, vanity with ample cupboard space, mirror, toilet facilities and an in-cabin safe.

Platinum Service guests can pre-board the train and relax in the Outback Explorer Lounge before departure at selected locations. Make yourself comfortable, enjoy a cool drink and meet your host and fellow travellers.

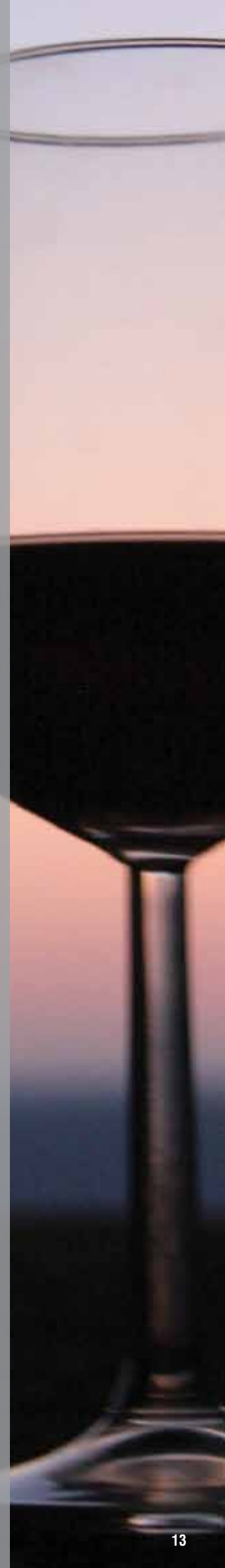

Platinum and Gold Service guests dine in the exclusive and elegant Queen Adelaide Restaurant, where delicious fresh Australian cuisine is prepared by on-board chefs.

Three meals a day are served: full or continental breakfasts, sumptuous lunches and a la carte dinners. Meals are accompanied by a selection of fine Australian wines or other beverages, included in your fare.

Explore parts of Australia along the way with our inclusive Off Train Excursions. Visit the Top End's magnificent Katherine Gorge, get to know legendary Alice Springs, see the Western Australia mining town of Kalgoorlie, Adelaide, the foodies paradise and explore the Outback city of Broken Hill.

Not good at travelling light? Don't worry, we've got it covered. The luggage allowance for all Platinum Service guests is a generous three pieces, weighing up to 25kg per piece. We recommend keeping a small bag in your cabin and storing the remainder of your belongings in our secure luggage carriage.

To top-off this premium Platinum Service experience, private transfers are provided at the start and conclusion of your journey. It's all about making your journey an unforgettable experience.



All onboard meals with regional menu.



Standard alcoholic/non alcoholic beverages.



Increased rail luggage allowance.



Off Train Excursions.



Private Transfers.



Gold Service

The romance of a bygone era with every modern comfort.

Whether you're a solo traveller, a couple, or travelling with friends, Gold Service will fulfil your expectations for a stylish journey and make your trip even more memorable.

Our comfortable cabins allow a choice of format. You can select a twin cabin configured as a three-seater lounge during the day and converting to upper and lower berths at night, with compact en suite facilities in your cabin.

If you're travelling alone, single cabins are configured as a lounge chair, converting to a bed at night, with shared bathroom facilities at the end of each carriage. Gold Service Single fares are also fully inclusive of all dining, standard beverages and Off Train Excursions.

Gold Service guests can enjoy pre-boarding the train and relaxing in the Outback Explorer Lounge before departure at selected locations. Make yourself comfortable, enjoy a welcome drink and meet your host and fellow travellers. You'll start to relax from the moment you step aboard.



Platinum and Gold Service guests dine in the exclusive Queen Adelaide Restaurant, where on-board chefs prepare distinctively Australian dishes. Full or continental breakfasts start the day, followed later by delicious lunches and fine a la carte dinners.

Freshly-prepared gourmet meals are accompanied by a selection of Australian wines and beverages, included in your fare.

Before or after dinner – or at any time of day – head to the relaxing Outback Explorer Lounge for a chat with fellow travellers, or to enjoy a nibble or a drink.

As a Gold Service guest, your fare also includes our Off Train Excursions at key points along your journey. Explore parts of Australia you've always wanted to see with memorable outings to Katherine Gorge, Alice Springs, Kalgoorlie, Adelaide and Broken Hill, depending on which journey you are taking.

We know that taking everything you need for your travels is essential to your comfort, so we provide a generous luggage allowance for all Gold Service guests, of two pieces, each of up to 25kg each.

We recommend keeping a small bag in your cabin and storing the remainder of your belongings in our secure luggage carriage.

Travelling Solo?

We offer an all year round standard discount off the Gold Service twin per person fare. With absolutely no single supplements on point-to-point rail travel in our Single Cabins. Our journeys offer fun, group oriented Off Train Excursions and the ability to make friends and socialise in the Outback Explorer Lounge or over dinner.



All onboard meals with regional menu.



Standard alcoholic/non alcoholic beverages.



Increased rail luggage allowance.



Off Train Excursions.



Gold Twin Berth Sleeper by day



Gold Twin Berth Sleeper by night



Gold Single Berth Sleeper by day



Gold Single Berth Sleeper by night



Red Service

A level of comfort to suit your travel style and budget.

Red Service provides travellers with the most economical way to travel without skimping on the important things like travelling in comfort, great food and beverages and most of all, a memorable rail experience.

The Red Service Day/Nighter Seats are two-abreast reclining chairs that can swivel to face each other if you're travelling in a group, or socialising with new-found friends. When you are ready to sleep, recline your chair to a comfortable 45 degree angle and settle in. Your shared toilet and shower facilities are located at the end of your carriage.

During the day, make your way to the Matilda Café, a great place to watch the passing scenery from the panoramic windows, purchase affordable, tasty light meals and enjoy a drink or two with friends.

The experience doesn't end here. Red Service guests are welcome to explore dedicated stops by purchasing their preferred tour from our friendly hospitality staff.

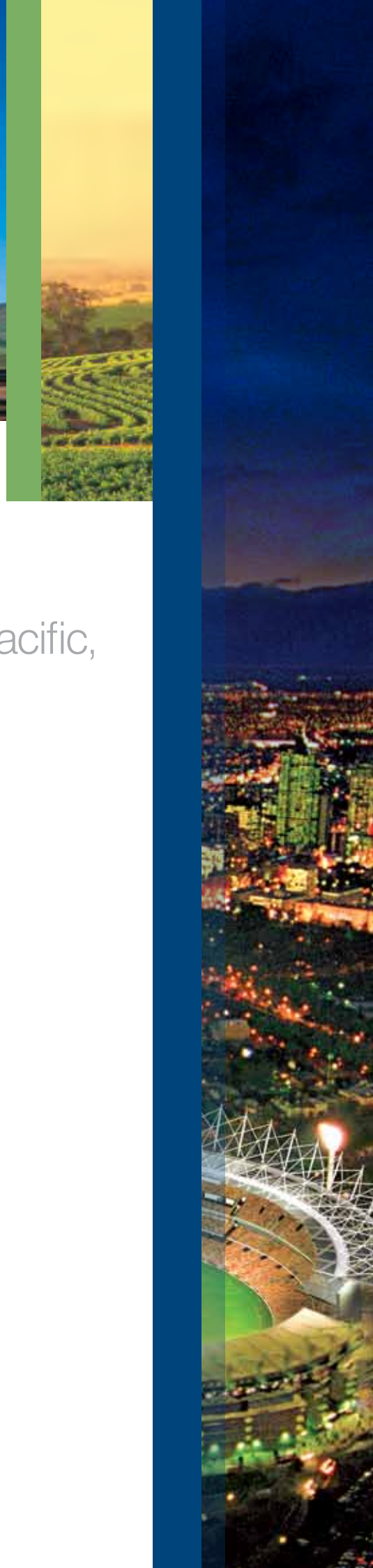

The Overland

Linking with The Ghan and Indian Pacific, The Overland is your gateway to an exciting Australian rail experience.

Connecting Australia's south-eastern cities, The Overland offers a relaxing and comfortable way to travel between Melbourne and Adelaide, and return.

The Overland is the gateway for your ultimate rail adventure, giving you the chance to access The Ghan from Adelaide to Darwin, or the Indian Pacific from Adelaide to Perth.

The Overland is a train rich with Australian history. Its name is inspired by the 'Overlanders', who travelled this fascinating countryside route on horseback. More than a century later, the modern-day 'Overlanders' enjoy the sights of the rugged mallee scrubland, fields of golden crops and vast open plains in relaxed comfort.

The historic one-day journey is the perfect introduction to your Australian rail experience.



The Journey

Melbourne to Adelaide or vice versa
– One day, one way, 828km.

Did you know?

The Overland is a fun and hassle-free way to get to major events such as AFL games and theatre productions in Melbourne or the Tour Down Under and music festivals in Adelaide.



**For further information or bookings
see your licenced travel agent.**

Your Travel Agent:



facebook.com/GreatSouthernRail